

A_CP COND

Modular premixed condensation gas water heater



Model	Thermal flow rated Kw	Power useful thermal kW	Volume Liters	Code	€
A_CP COND 34.5 METHANE	34,5	36,2	385	37301300	11.600,00
A_CP COND 45.0 METHANE	45,0	47,2	382	37301301	14.000,00
A_CP COND 60.0 METHANE	60,0	63,0	379	37301302	15.100,00
A_CP COND 34.5 LPG	34,5	36,2	385	37301310	11.600,00
A_CP COND 45.0 LPG	45,0	47,2	382	37301311	14.000,00
A_CP COND 60.0 LPG	60,0	63,0	379	37301312	15.100,00

Accessories A_CP COND

SPLIT KIT

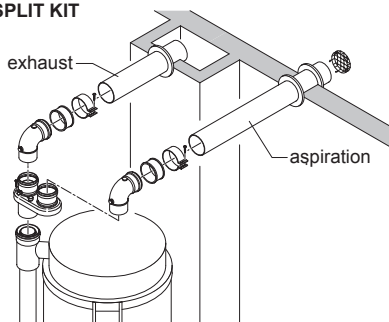

horizontal split exhaust kit including:

- n. 1 80/125 to 80/80 splitter with gaskets
- n. 2 x 1 meter tubes
- n. 1 smoke exhaust terminal
- n. 4 Ø 80 wall-covering rosettes
- n. 1 air intake terminals
- n. 2 curves Ø 80 to 90 °
- Maximum length without changes of direction 20 meters (as a sum of suction and discharge)

37301320

308,00

COAXIAL KIT FOR WALLS

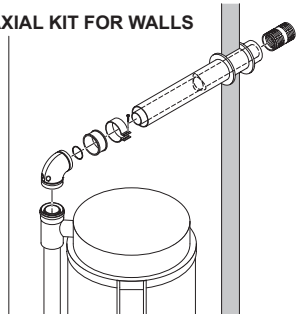

horizontal coaxial kit including:

- n. 1 coaxial tube from Ø 80/125 with terminal
- n. 4 wall-covering rosettes Ø 125
- n. 1 coaxial curve Ø 80/125 to 90°
- Maximum length without changes of direction 3 meters

37301321

230,00

A_CP COND

Modular premixed condensation gas water heater

Dimensions and dimensions A_CP COND

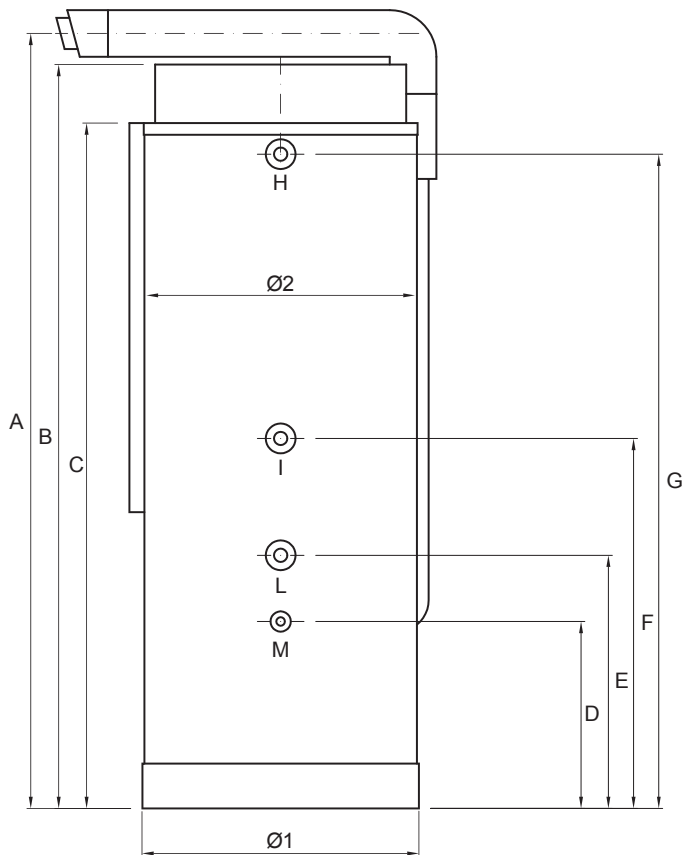

A	1990 mm
B	1910 mm
C	1760 mm
D	480 mm
E	650 mm
F	950 mm
G	1680 mm
H	1"1/4 DHW output
I	DHW recirculation 1"1/4
L	DHW entry 1"1/4
M	3/4" loading cockpit
Ø1	710 mm
Ø2	690 mm

Technical data table for water heaters A_CP COND 50÷120

DESCRIPTION	U.M.	A_CP COND 34.5	A_CP COND 45.0	A_CP COND 60.0
Effective capacity	l	385	382	379
Nominal thermal flow	kW	34,5	45,0	60,0
Useful thermal power	kW	36,2	47,2	63,0
Yield	%	106	106	106
Running time 50 °C*	min	31	21	16
Running time 60 °C*	min	40	27	20
Running time 70 °C*	min	51	33	25
Running time 80 °C*	min	58	39	29
Continuous hourly production 40 °C*	min	1030	1548	2064
Continuous hourly production 45 °C*	min	862	1290	1474
Continuous hourly production 50 °C*	min	735	1105	1105
Continuous hourly production 60 °C*	min	573	860	1146
Continuous hourly production 70 °C*	min	469	703	938
Methane gas consumption (G20)	m ³ /h	3,17	4,76	6,35
LPG gas consumption	Kg/h	2,24	3,36	4,48
Power supply		230V/1/50Hz		
Electric power absorbed	W	100		
Max water pressure	bar	6		
NOx Class		6		
Empty weight	Kg	105	109	113
Weight to full	Kg	490	491	492

(* Inlet water temperature 15 °C