

# WP1 V - WP2 V

Enamelled glass boilers with oversized exchangers for DHW production from HP



## Technical and construction characteristics

The high-performance boilers of the WP1 V and WP2 V series are suitable for installation in civil and industrial systems for the production of domestic hot water.

They allow obtaining high heat exchange yields with consistent hourly production of domestic hot water.

The WP1 V boiler is equipped with a single internal fixed exchanger with an increased surface area, suitable for being powered by heat pumps.

The WP2 V boiler, in addition to the oversized exchanger dedicated to the heat pump, is equipped with a second lower fixed exchanger for solar thermal integration.

Both boilers are made of enamelled carbon steel (S 235 Jr) with internal protective treatment.







The inorganic food glazing complies with DIN 4753.3.

The external protective treatment is made with anti-rust paint and industrial enamel.

The insulation is in rigid polyurethane with sky covering. The boilers are equipped as standard with cathodic protection with a magnesium anode.

Model	Code	€
Enamelled glass heat pump boiler WP1 V 200	37304007	1.630,00
Enamelled glass heat pump boiler WP1 V 300	37304000	2.250,00
Enamelled glass heat pump boiler WP1 V 400	37304001	2.830,00
Enamelled glass heat pump boiler WP1 V 500	37304002	3.100,00
Enamelled glass heat pump boiler WP1 V 600	37304003	3.550,00
Enamelled glass heat pump boiler WP1 V 800	37304004	4.300,00
Enamelled glass heat pump boiler WP1 V 1000	37304005	4.490,00
Enamelled glass heat pump boiler WP1 V 1500	37304006	7.640,00
Enamelled glass heat pump boiler double coil WP2 V 300	37304298	2.660,00
Enamelled glass heat pump boiler double coil WP2 V 400	37304299	2.880,00
Enamelled glass heat pump boiler double coil WP2 V 500	37304300	3.480,00
Enamelled glass heat pump boiler double coil WP2 V 600	37304301	4.310,00
Enamelled glass heat pump boiler double coil WP2 V 800	37304302	4.720,00
Enamelled glass heat pump boiler double coil WP2 V 1000	37304303	5.490,00
Enamelled glass heat pump boiler double coil WP2 V 1500	37304304	8.570,00

## Accessories WP1 V - WP2 V

	Imposed electronic anode immediately	mod. till 1000 l mod. 1500 l	75060401 75060399	230,00 276,00
	Electronic control unit		75060402	470,00
	Thermostat pour eau chaude avec puits 1/2" L 100 mm		75060403	76,00
	Hot water thermometer with well 1/2" L 100 mm		75060404	26,00
	230 V single-phase integrative electrical resistance IP 65 protection rating	mod. 1500 W mod. 2000 W mod. 3000 W	75050102 75050103 75060300	200,00 220,00 240,00
	400 V three-phase integrative electrical resistance IP 65 protection rating	mod. 6000 W mod. 9000 W	75050105 75050106	528,00 534,00

# WP1 V - WP2 V

Enameled glass boilers with oversized exchangers for DHW production from HP

## Technical features WP1 V

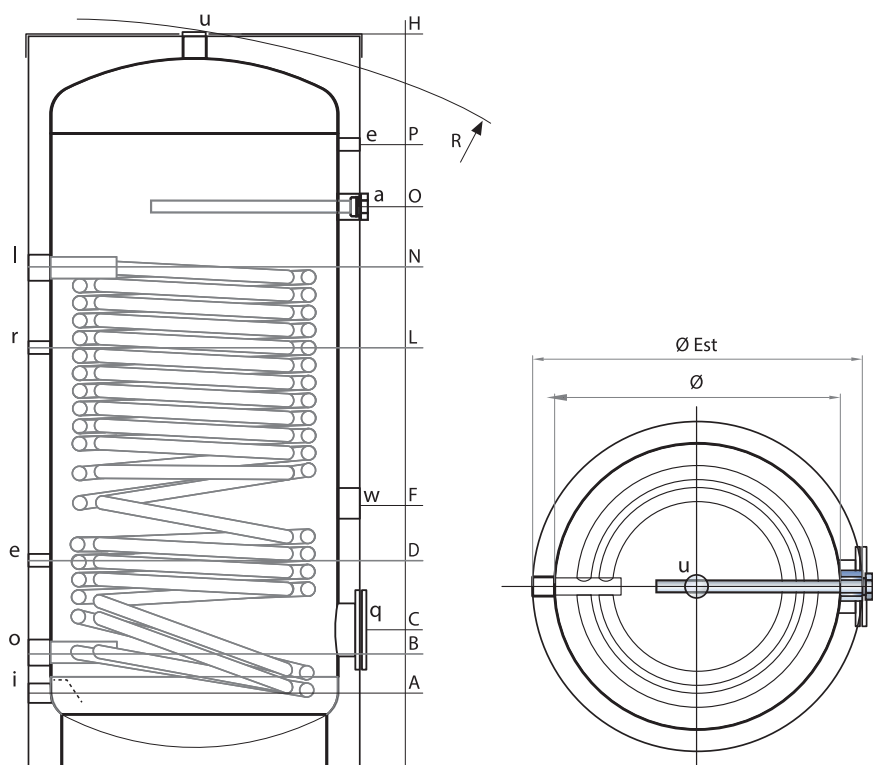

### Legend

- a Magnesium anode
- e Thermometer-probe
- i Domestic cold water inlet
- l Heat pump delivery
- o Heat pump return
- q Sanitary inspection flange
- r Recirculation
- u Domestic hot water outlet
- x Solar delivery
- w Preparation of electrical resistance

### Gas connections WP1 V

Liter	a l o	e	r	i	u	w	q (mm)
200	1"1/4	1/2"	1/2"	1"	1"1/4	1"1/2	120/180
300	1"1/4	1/2"	1/2"	1"	1"1/4	1"1/2	120/180
400	1"1/4	1/2"	1/2"	1"	1"1/4	1"1/2	120/180
500	1"1/4	1/2"	1/2"	1"	1"1/4	1"1/2	120/180
600	1"1/4	1/2"	1/2"	1"	1"1/4	1"1/2	120/180
800	1"1/4	1/2"	1"	1"1/2	1"1/2	1"1/2	120/180
1000	1"1/4	1/2"	1"	1"1/2	1"1/2	1"1/2	120/180
1500	1"1/4	1/2"	1"	2"	2"	1"1/2	220/290

### Technical data table WP1 V

Liter	Dimensions (mm)				Quote (mm)								Exchanger m <sup>2</sup>	Weight Kg
	I	Ø	H	Ø Est	A	B	C	D	F	L	N	O		
200	450	1320	550	95	187	262	342	623	743	953	953	1087	2,10	78
300	500	1580	600	120	210	300	320	495	925	1110	1160	1365	3,50	110
400	650	1380	750	145	240	310	340	525	870	1005	1030	1140	4,50	133
500	650	1630	750	145	240	310	350	570	1020	1250	1280	1390	5,70	159
600	650	1880	750	145	240	310	390	605	1070	1250	1510	1640	5,70	167
800	790	1735	990	150	275	345	405	620	1000	1170	1310	1425	6,00	215
1000	790	2080	990	150	275	345	475	750	1120	1275	1615	1770	6,00	251
1500	1000	2115	1200	230	345	475	535	805	1165	1325	1600	1740	7,50	383

Materials	Porcelain glass (S 235 Jr)
Porcelain glass	Internal protective treatment with inorganic food-grade enamelling compliant with standards DIN 4753.3
Treat. external protection	Painting with anti-rust and industrial enamel
Treat. external protection	8 bar / 95°C
Exchanger operation	12 bar / 95°C
Insulation	Flexible insulation in polyester + PVC fire resistance class B2 (DIN 4102)
Cathodic protection	Magnesium anode

# WP1 V - WP2 V

Enameled glass boilers with oversized exchangers for DHW production from HP

## Technical features WP2 V

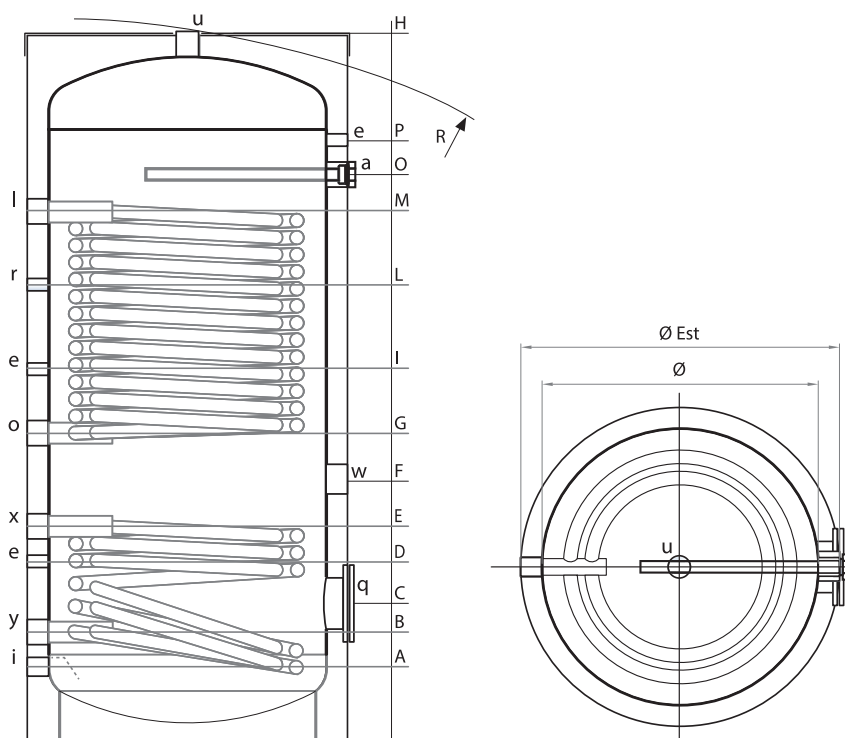

### Legend

- a Magnesium anode
- e Thermometer-probe
- i Domestic cold water inlet
- l Heat pump delivery
- o Heat pump return
- q Sanitary inspection flange
- r Recirculation
- u Domestic hot water outlet
- w Preparation of electrical resistance
- x Solar delivery
- y Solar return

### Gas connections WP2 V

Liter	a l o x y	e	r	i	u	w	q (mm)
300	1"1/4	1/2"	1/2"	1"	1"1/4	1"1/2	120/180
400	1"1/4	1/2"	1/2"	1"	1"1/4	1"1/2	120/180
500	1"1/4	1/2"	1/2"	1"	1"1/4	1"1/2	120/180
600	1"1/4	1/2"	1/2"	1"	1"1/4	1"1/2	120/180
800	1"1/4	1/2"	1"	1"1/2	1"1/2	1"1/2	120/180
1000	1"1/4	1/2"	1"	1"1/2	1"1/2	1"1/2	120/180
1500	1"1/4	1/2"	1"	2"	2"	1"1/2	220/290

### Technical data table WP2 V

Liter	(Dimensions mm)				Quote (mm)												Exchanger		Weight
	I	Ø	H	Ø Est	R	A	B	C	D	E	F	G	I	L	M	O	P	Inf. m <sup>2</sup>	Sup. m <sup>2</sup>
300	500	1610	600	1730	120	210	300	320	430	495	560	745	925	1110	1160	1365	1,00	2,40	108
400	650	1410	750	1610	145	240	310	340	440	525	565	720	870	1005	1030	1140	1,20	3,00	128
500	650	1660	750	1835	145	240	310	350	460	570	610	820	1020	1250	1280	1390	1,50	4,20	159
600	650	1910	750	2065	145	240	310	390	540	605	670	870	1070	1470	1510	1640	2,00	5,00	188
800	790	1750	990	1745	150	275	345	405	535	620	665	835	1000	1270	1310	1425	2,00	5,20	234
1000	790	2110	990	2095	150	275	345	475	675	750	825	975	1120	1575	1615	1770	3,30	6,00	285
1500	1000	2115	1200	2145	230	345	475	535	730	805	880	1025	1165	1560	1600	1740	3,60	7,50	417

Materials	Porcelain glass (S 235 Jr)
Porcelain glass	Internal protective treatment: inorganic food-grade enamelling compliant with standards DIN 4753.3
Treat. External protective	Painting with anti-rust and industrial enamel
Boiler exercise	8 bar / 95°C
Exchanger operation	12 bar / 95°C
Insulation	Flexible insulation in polyester + PVC fire resistance class B2 (DIN 4102)
Cathodic protection	Magnesium anode