

MEC 35÷85 EX C

Wall-mounted ducted air heaters for outdoor installation



Remote control
supplied with
standard delivery



Model	Heat Input kW	Heat Output kW	Code	€
MEC 35 EX C ducted for outdoor	34,80	31,90	30240000	4.320,00
MEC 57 EX C ducted for outdoor	57,00	51,60	30340000	6.510,00
MEC 85 EX C ducted for outdoor	85,00	75,60	30390000	9.630,00

Air delivery duct coupling

MEC 35 EX C (included in the price)	30192200	190,00
MEC 57 EX C (included in the price)	30292200	218,00
MEC 85 EX C (included in the price)	30392200	296,00

Air intake duct coupling:

MEC 35 EX C (included in the price)	30242250	270,00
MEC 57 EX C (included in the price)	30342250	400,00
MEC 85 EX C (included in the price)	30392250	550,00

Accessoires MEC EX C





Weekly programmable thermostat
with integrated GSM

36205222

550,00

MEC 35÷85 EX C

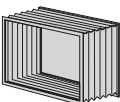
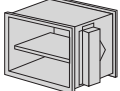
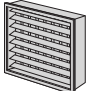
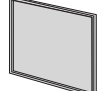
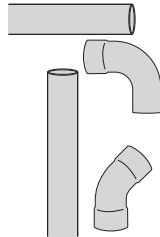
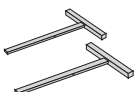
Wall-mounted ducted air heaters for outdoor installation

Accessoires MEC EX C		Code	€	
	Ducting vibration damper	mod. 35	30172230	212,00
		mod. 57	30322230	318,00
		mod. 85	30372230	380,00
	Ducting fire damper REI 120	mod. 35	30172205	1.060,00
		mod. 57	30322205	1.166,00
		mod. 85	30372205	1.484,00
	Air delivery grate	mod. 35	30172210	340,00
		mod. 57	30322210	424,00
		mod. 85	30372210	614,00
	Air intake filter	mod. 35	30175610	72,00
		mod. 57	30325610	70,00
		mod. 85	30375610	126,00
	Ducts and elbows (Ø 80 MEC 25÷35) (Ø100 MEC 50÷85)	duct m 1 Ø 80	37800035	72,00
		duct m 1 Ø 100	37800050	80,00
		elbow 90° Ø 80	37800030	58,00
		elbow 90° Ø 100	37800031	70,00
		elbow 45° Ø 80	37800032	66,00
		elbow 45° Ø 100	37800034	70,00
		elbow with condensate drain Ø 80	37800037	82,00
elbow with condensate drain Ø 100	37800039	78,00		
	Holders		30240090	110,00
	Exhaust sampling plug		30170057	15,00

Examples of installations MEC EX C

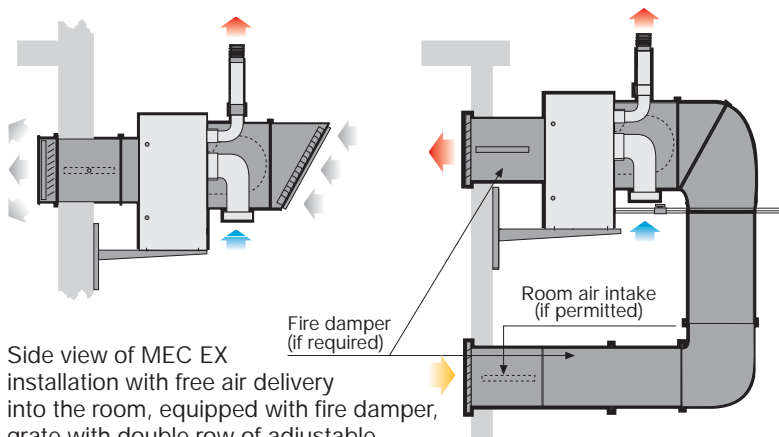

Installation carried out by using the following accessories:

- fire damper REI 120
- air delivery grate with double row of adjustable flaps
- air intake filter
- holders

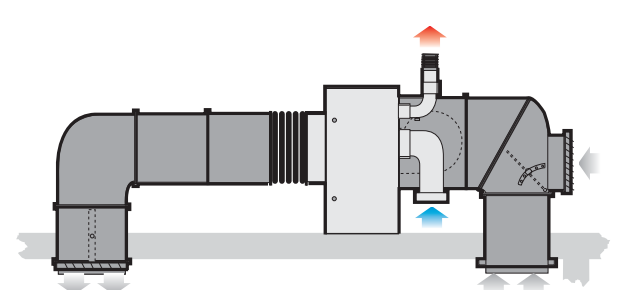

Installation carried out by using the following accessories:

- fire damper REI 120
- vibration damper

MEC 35÷85 EX C

Wall-mounted ducted air heaters for outdoor installation

Dimensions MEC 35 EX C

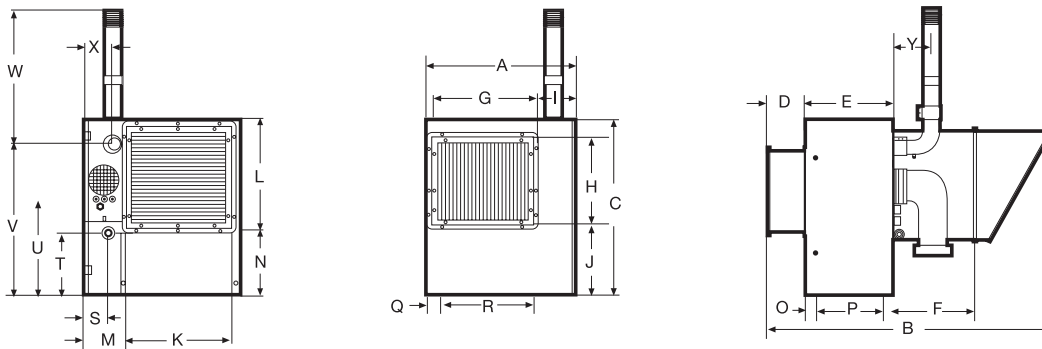

A	695	L	472	V	695
B	1386	M	187	W	685
C	840	N	305	X	120
D	167	O	48	Y	160
E	415	P	315	Air	Ø 140
F	402	Q	76	Exhaust	Ø 80
G	470	R	398	Gas	1/2"
H	400	S	113		
I	195	T	283		
J	330	U	440		
K	470				Values in mm

Dimensions MEC 57 EX C

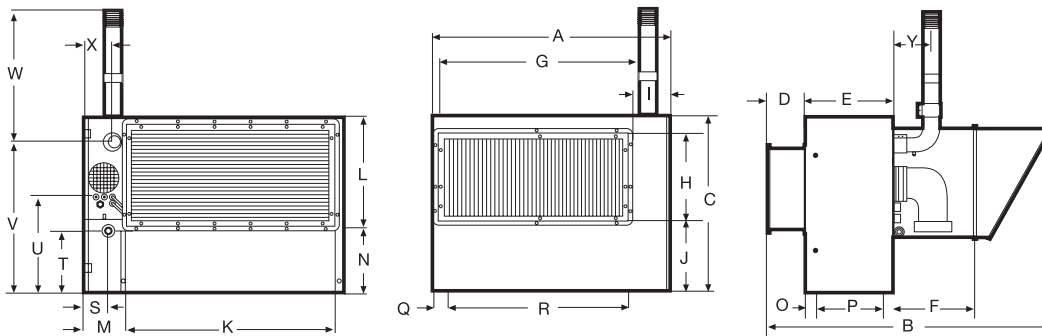

A	1147	L	475	V	695
B	1035	M	187	W	665
C	840	N	255	X	113
D	167	O	48	Y	136
E	415	P	315	Air	Ø 140
F	402	Q	81	Exhaust	Ø 80
G	922	R	840	Gas	1/2"
H	400	S	113		
I	195	T	290		
J	330	U	440		
K	937				Values in mm

Dimensions MEC 85 EX C

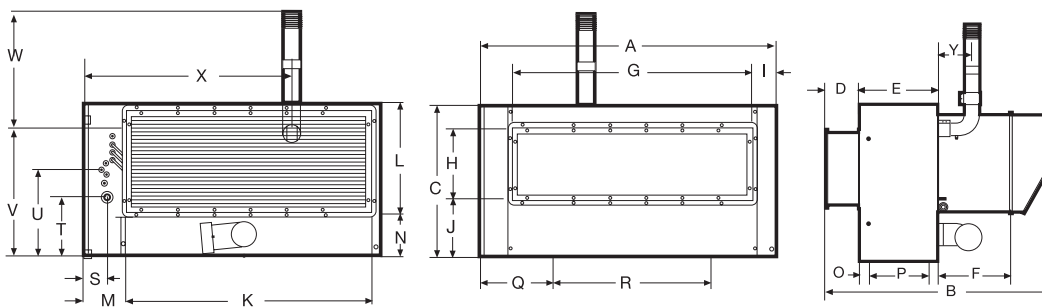

A	1748	L	545	V	715
B	1345	M	160	W	665
C	870	N	255	X	1133
D	102	O	48	Y	136
E	480	P	315	Air	Ø 140
F	402	Q	424	Exhaust	Ø 80
G	1360	R	900	Gas	1/2"
H	400	S	113		
I	195	T	353		
J	330	U	515		
K	1450				Values in mm

Technical datasheet MEC 35-85 EX C

Description	U.M.	MEC 35 EX C	MEC 57 EX C	MEC 85 EX C
Heat Output	kW	31,90	51,60	75,60
Heat Input	kW	34,80	57,00	85,00
Gas flow rate	<i>Methane G20</i> <i>Butane G30</i> <i>Propane G31</i>	m ³ /h kg/h kg/h	3,70 2,76 2,71	6,03 4,49 4,42
min-max (15 °C - 1.013 mbar)				9,00 6,70 6,60
Burner	<i>G20 p 20 mbar</i> <i>G30 p 28-30 mbar</i> <i>G31 p 37 mbar</i>	mbar	12,0 27,4 36,0	10,5 24,2 32,5
gas pressure (15 °C - 1.013 mbar)				11,0 25,0 32,5
Nozzles diameter	<i>G20</i> <i>G30/G31</i>	mm/100 mm/100	350 210	370 220
Gas supply connection			G 1/2"	
Air intake diameter	mm		140	
Exhaust flue diameter	mm	80	100	
Power supply			230V/1/50Hz	
Air flow rate	m ³ /h	2500	5000	7300
Revolution per minute	n.	930	930	950
Air throw	Pa	100	100	100
Air temperature rise	°C	37	31	31
Noise level (at 5 m)	dB(A)	48,5	51,5	53,0
Degree of protection			IP 44	
Max. power input	W	850	1050	2500
Fuse	A	6,3	10,0	15,0
Net weight	Kg	73	125	207